

Lead-through Bolt: Type 421



These high quality lead-through bolts feature very low resistance and great durability. They are designed for use in test facilities, laboratory facilities and in bushings for transformers and chokes.

- ◆ Rugged construction
- ◆ Cost effective
- ◆ Oiltight

Technical Data

Design current: 16 Amp

Material:

- metal parts: brass
- insulated parts: moulded bakelite

Temperature stability: 100°C

Working voltage: 1000 V

Insulation co-ordination: 5 kV / 1

Design impact potential: 5 kV

Testing voltage: 3200 V

Conducting wall thickness: 10mm

Creep distance (SK max.): 16.5mm

Insulation resistance: >10⁹ ohm

Pass-through resistance: 0.7 megaohm

Starting torque: 1.2Nm

Industry Usage

Radio, Sound, Electronic test equipment, Laboratory facilities

ENERCOP instruments ltd

170 Wilkinson Road, Unit 13, Brampton, ON, L6T 4Z5 Canada

Tel: 416-231-5335, Toll free: 1-800-363-7267

enercorp.com

All measurements in mm

Type 421

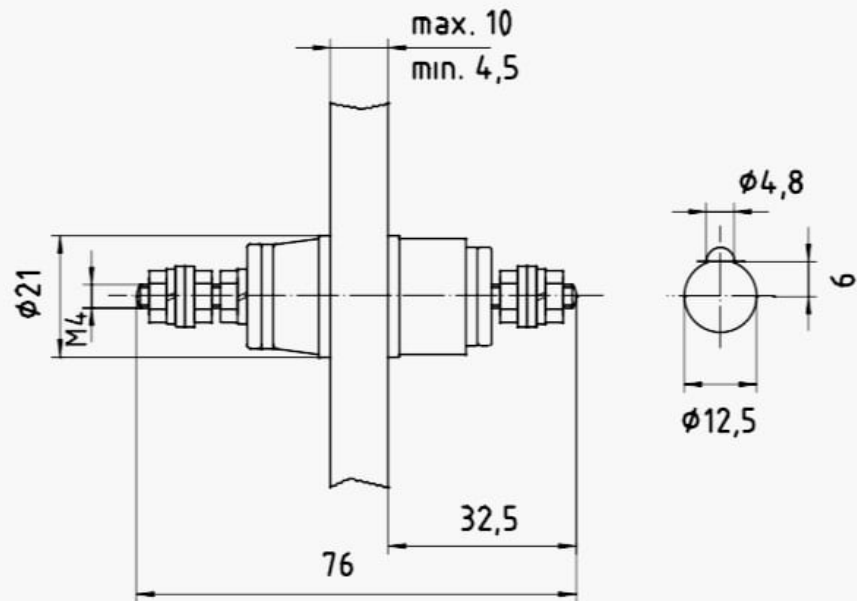

16 A

Ordering Data

8774210100

ENERCOP instruments ltd

170 Wilkinson Road, Unit 13, Brampton, ON, L6T 4Z5 Canada

Tel: 416-231-5335, Toll free: 1-800-363-7267

enercorp.com